

| Designation | DC | DCX | CICT | DCSFMS | LF | DCONMS | CBDP | KWW | b | WT(kg) | Air hole | Insert |
|-------------------|-----|-----|------|--------|----|--------|------|------|-----|--------|----------|-----------|
| TAW13R050M22.0-03 | 50 | 63 | 3 | 41 | 40 | 22 | 20 | 10 | 6 | 0.4 | With | SW*T13... |
| TAW13R050M22.0-04 | 50 | 63 | 4 | 41 | 40 | 22 | 20 | 10 | 6 | 0.4 | With | SW*T13... |
| TAW13R050M22.0E04 | 50 | 63 | 4 | 41 | 40 | 22 | 20 | 10.4 | 6.3 | 0.4 | With | SW*T13... |
| TAW13R050M22.0E05 | 50 | 63 | 5 | 41 | 40 | 22 | 20 | 10.4 | 6.3 | 0.4 | With | SW*T13... |
| TAW13R063M22.0-04 | 63 | 76 | 4 | 41 | 40 | 22 | 20 | 10 | 6 | 0.5 | With | SW*T13... |
| TAW13R063M22.0-05 | 63 | 76 | 5 | 41 | 40 | 22 | 20 | 10 | 6 | 0.6 | With | SW*T13... |
| TAW13R063M22.0E05 | 63 | 76 | 5 | 41 | 40 | 22 | 20 | 10.4 | 6.3 | 0.6 | With | SW*T13... |
| TAW13R063M22.0E06 | 63 | 76 | 6 | 41 | 40 | 22 | 20 | 10.4 | 6.3 | 0.6 | With | SW*T13... |
| TAW13R080M25.4-04 | 80 | 94 | 4 | 50 | 50 | 25.4 | 26 | 9.5 | 6 | 1 | With | SW*T13... |
| TAW13R080M25.4-06 | 80 | 94 | 6 | 50 | 50 | 25.4 | 26 | 9.5 | 6 | 1 | With | SW*T13... |
| TAW13R080M27.0E06 | 80 | 94 | 6 | 50 | 50 | 27 | 22 | 12.4 | 7 | 1 | With | SW*T13... |
| TAW13R080M27.0E08 | 80 | 94 | 8 | 50 | 50 | 27 | 22 | 12.4 | 7 | 1 | With | SW*T13... |
| TAW13R100M31.7-05 | 100 | 114 | 5 | 60 | 50 | 31.75 | 32 | 12.7 | 8 | 1.5 | With | SW*T13... |
| TAW13R100M31.7-07 | 100 | 114 | 7 | 60 | 50 | 31.75 | 32 | 12.7 | 8 | 1.5 | With | SW*T13... |
| TAW13R100M32.0E07 | 100 | 114 | 7 | 60 | 50 | 32 | 28.5 | 14.4 | 8 | 1.5 | With | SW*T13... |
| TAW13R100M32.0E10 | 100 | 114 | 10 | 60 | 50 | 32 | 28.5 | 14.4 | 8 | 1.5 | With | SW*T13... |
| TAW13R125M38.1-06 | 125 | 139 | 6 | 80 | 63 | 38.1 | 38 | 15.9 | 10 | 2.8 | With | SW*T13... |
| TAW13R125M38.1-08 | 125 | 139 | 8 | 80 | 63 | 38.1 | 38 | 15.9 | 10 | 2.7 | With | SW*T13... |
| TAW13R125M40.0E08 | 125 | 139 | 8 | 80 | 63 | 40 | 32 | 16.4 | 9 | 2.7 | With | SW*T13... |
| TAW13R125M40.0E12 | 125 | 139 | 12 | 80 | 63 | 40 | 32 | 16.4 | 9 | 3 | With | SW*T13... |
| TAW13R160M40.0E10 | 160 | 174 | 10 | 100 | 63 | 40 | 29 | 16.4 | 9 | 4.4 | Without | SW*T13... |
| TAW13R160M40.0E16 | 160 | 174 | 16 | 100 | 63 | 40 | 29 | 16.4 | 9 | 4.4 | Without | SW*T13... |
| TAW13R160M50.8-07 | 160 | 174 | 7 | 100 | 63 | 50.8 | 40 | 19 | 11 | 4.4 | Without | SW*T13... |
| TAW13R160M50.8-10 | 160 | 174 | 10 | 100 | 63 | 50.8 | 40 | 19 | 11 | 4.4 | Without | SW*T13... |
| TAW13R200M47.6-08 | 200 | 213 | 8 | 130 | 63 | 47.625 | 38 | 25.4 | 14 | 8 | Without | SW*T13... |

*Recommended clamping torque (N·m): CSPB-3.5=3.5

SPARE PARTS

| Designation | ③ Clamping screw | Lubricant | ① Shim screw | Shell locking bolt 1 | Shell locking bolt 2 | ② Shim | Wrench | Wrench 1 |
|--------------------|------------------|-----------|--------------|----------------------|----------------------|----------|--------|----------|
| TAW13R050 - 063... | CSPB-3.5 | M-1000 | DTS5-3.5SS | - | CM10X30H | FSSA1102 | IP-15D | P-3.5 |
| TAW13R080... | CSPB-3.5 | M-1000 | DTS5-3.5SS | - | CM12X30H | FSSA1102 | IP-15D | P-3.5 |
| TAW13R100... | CSPB-3.5 | M-1000 | DTS5-3.5SS | TMBA-M16H | - | FSSA1102 | IP-15D | P-3.5 |
| TAW13R125... | CSPB-3.5 | M-1000 | DTS5-3.5SS | TMBA-M20H | - | FSSA1102 | IP-15D | P-3.5 |
| TAW13R160... | CSPB-3.5 | M-1000 | DTS5-3.5SS | - | - | FSSA1102 | IP-15D | P-3.5 |
| TAW13R200... | CSPB-3.5 | M-1000 | DTS5-3.5SS | - | - | FSSA1102 | IP-15D | P-3.5 |

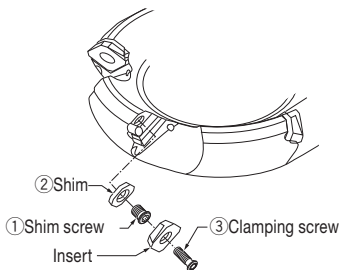

Reference pages: Inserts → **H075**, Standard cutting conditions → **H076 - H077**